

SAFETY, HEALTH AND ENVIRONMENTAL INFORMATION

ALL WORK TO BE CARRIED OUT IN ACCORDANCE WITH CURRENT CDM REGULATIONS 2015 AND HSG150. IN ADDITION TO THE HAZARDS/RISKS NORMALLY ASSOCIATED WITH THE TYPES OF WORK DETAILED ON THIS DRAWING, PLEASE NOTE THE FOLLOWING:

- KEY**
- EXISTING DCWW COMBINED SEWER
 - - - PROPOSED FOUL SEWER
 - PROPOSED SURFACE WATER SEWER (ATTENUATED DEVELOPMENT RUNOFF)
 - PROPOSED CULVERTED WATERCOURSE

- NOTES**
1. DRAINAGE STRATEGY SHOWN IS INDICATIVE OF DESIGN INTENT ONLY AND REMAINS SUBJECT TO DETAILED DESIGN AND FORMAL APPROVALS
 2. DRAINAGE PRINCIPLES MIMIC THOSE ESTABLISHED BY PREVIOUSLY APPROVED SCHEME (REF MHDS DRAWING 3174_120 REV J)
 3. MAIN CARRIER DRAINAGE SHOWN ONLY - PLOT DRAINAGE OMITTED FOR CLARITY
 4. FOUL DRAINAGE TO BE OFFERED FOR DCWW ADOPTION UNDER S104 AGREEMENT
 5. PHILOSOPHY OF CULVERTING OF ORDINARY WATERCOURSES ESTABLISHED BY PREVIOUS PLANNING APPLICATION
 6. PROPOSED DEVELOPMENT'S SURFACE WATER SYSTEM DISCHARGE RATES BASED ON GREENFIELD RATE OF 20l/sha APPLIED ON A PRO-RATA BASIS TO CONTRIBUTING HARDSTANDING AREAS. STORAGE PROVIDED TO CATER FOR Q100+30%CC EVENT.

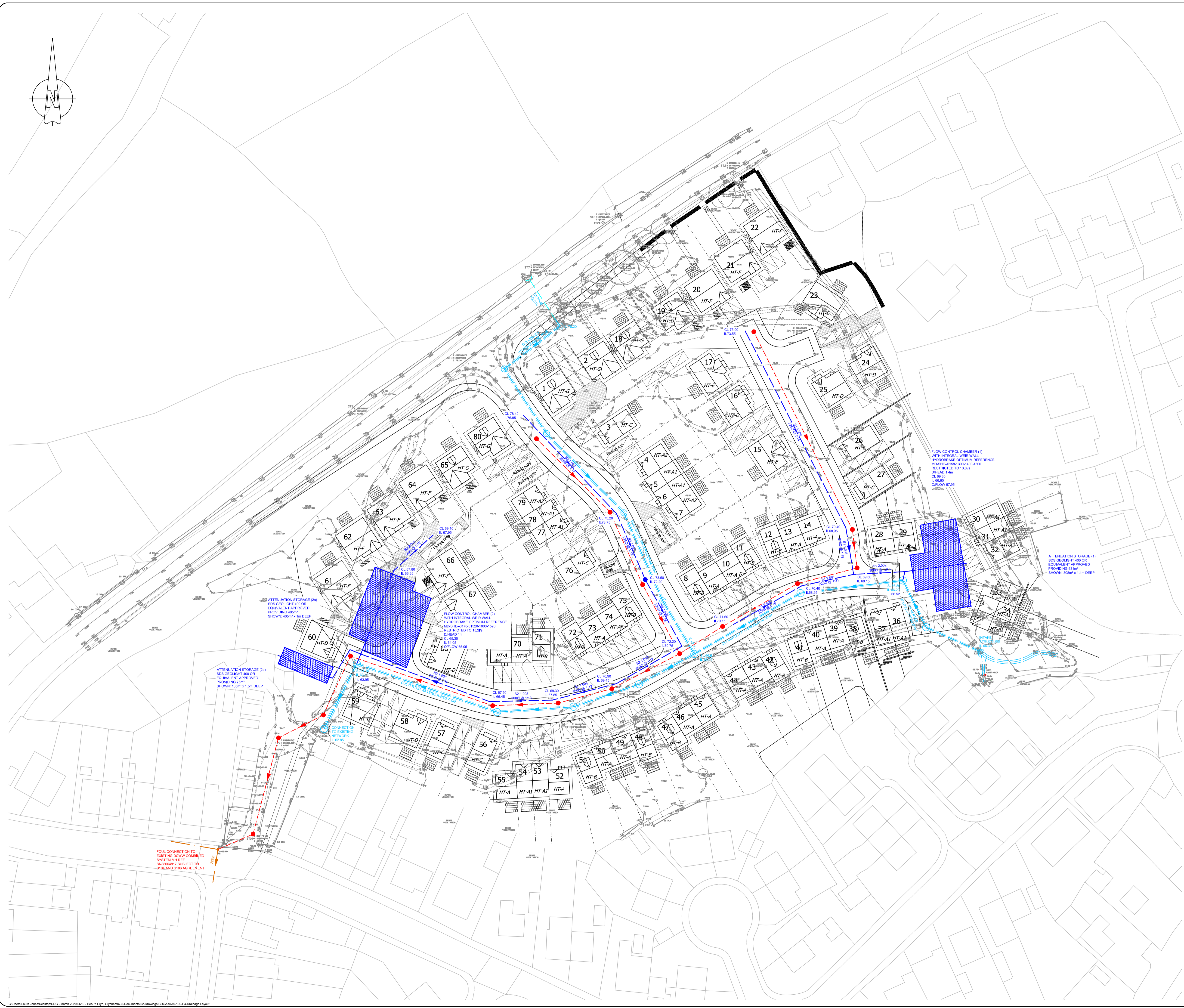

P4	CULVERT SIZES	LJ	23/12/20
P3	NPTC/BC COMMENTS SW MODELLED	LJ	30/07/20
P2	CULVERT ALIGN	LJ	27/07/20
REV	DESCRIPTION	BY	DATE

status

PRELIMINARY

CDGray
CIVIL & STRUCTURAL ENGINEERS

5-6 Deryn Court,
Wharfedale Road,
Pentwyn,
Cardiff, CF23 7HB
Tel: 02920 733181
Web: www.cdgray.co.uk

client

ENZO HOMES

project

**HEOL Y GLYN
GLYNNEATH**

drawing title

**PROPOSED DRAINAGE
LAYOUT**

drawn	LKJ	chkd	-	project no.	9610
date drawn	28.05.20	sig. no.	100	rev.	P4
scale	@A1				
	1:500				