

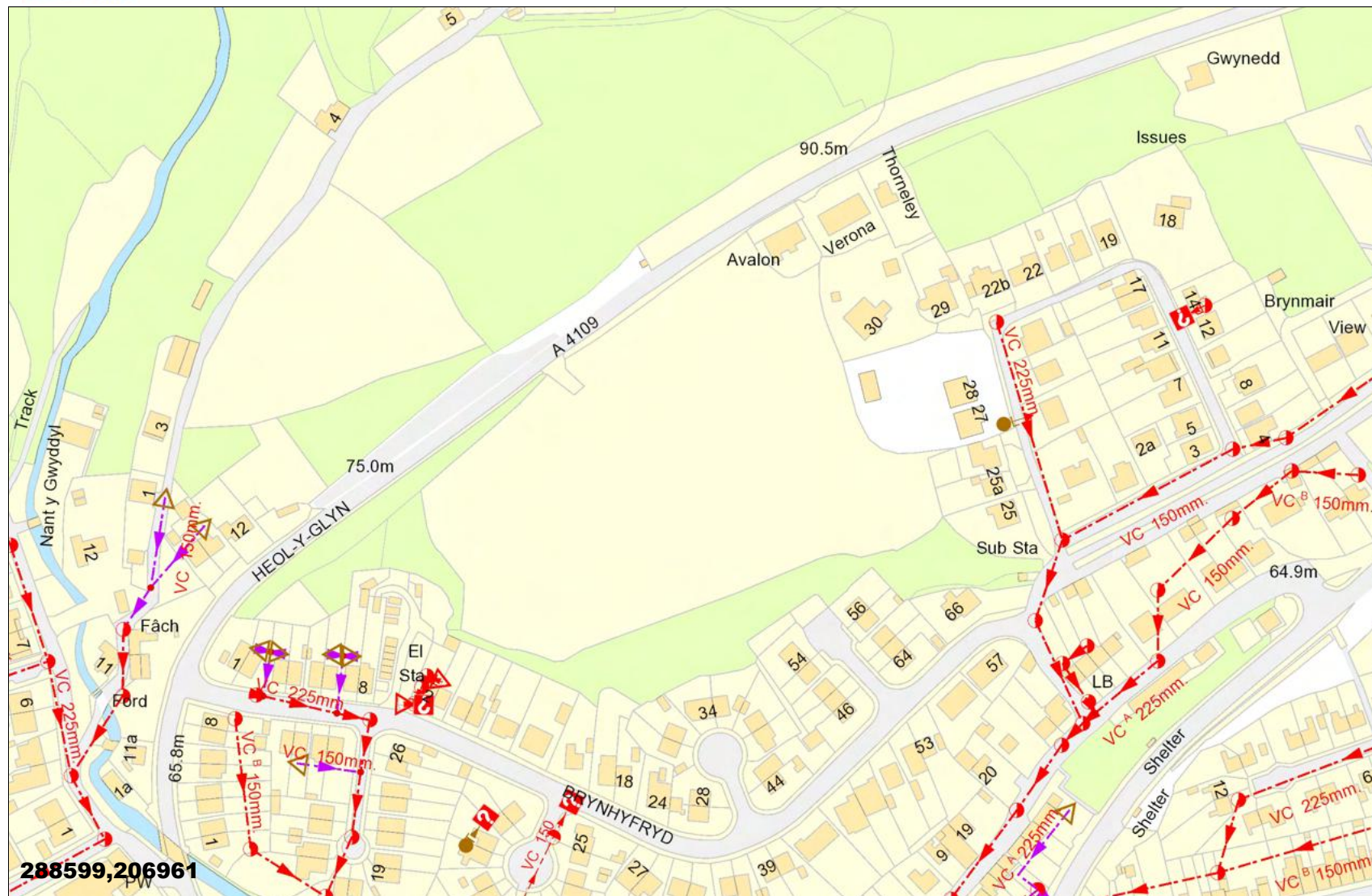

Scale: 1: 2500



288599,206961

Dŵr Cymru Cyfyngedig ('the Company') gives this information as to the position of its underground apparatus by way of general guidance only and on the strict understanding that it is based on the best information available and no warranty as to its correctness is relied upon in the event of excavations or other works made in the vicinity of the company's apparatus and any onus of locating the apparatus before carrying out any excavations rests entirely on you. The information which is supplied hereby by the company, is done so in accordance with statutory requirements of sections 198 and 199 of the Water Industry Act 1991 based upon the best information available and in particular, but without prejudice to the generality of the foregoing, it should be noted that the records that are available to the Company may not disclose the existence of a drain sewer or disposal main laid before 1 September 1989, or if they do, the particulars thereof including their position underground may not be accurate. It must be understood that the furnishing of this information is entirely without prejudice to the provision of the New Roads and Street Works Act 1991 and the company's right to be compensated for any damage to its apparatus.

**EXACT LOCATION OF
ALL APPARATUS TO
BE DETERMINED ON
SITE**

Reproduced from the Ordnance Survey's maps with the permission of the Controller of Her Majesty's Stationary Office. Crown Copyright. Licence No: WU298565.

Whilst every reasonable effort has been taken to correctly record the pipe material of DCWW assets, there is a possibility that in some cases pipe material (other than Asbestos Cement or Pitch Fibre) may be found to be Asbestos Cement (AC) or Pitch Fibre (PF). It is therefore advisable that the possible presence of AC or PF pipes be anticipated and considered as part of any risk assessment prior to excavation.



Scale: 1: 3730

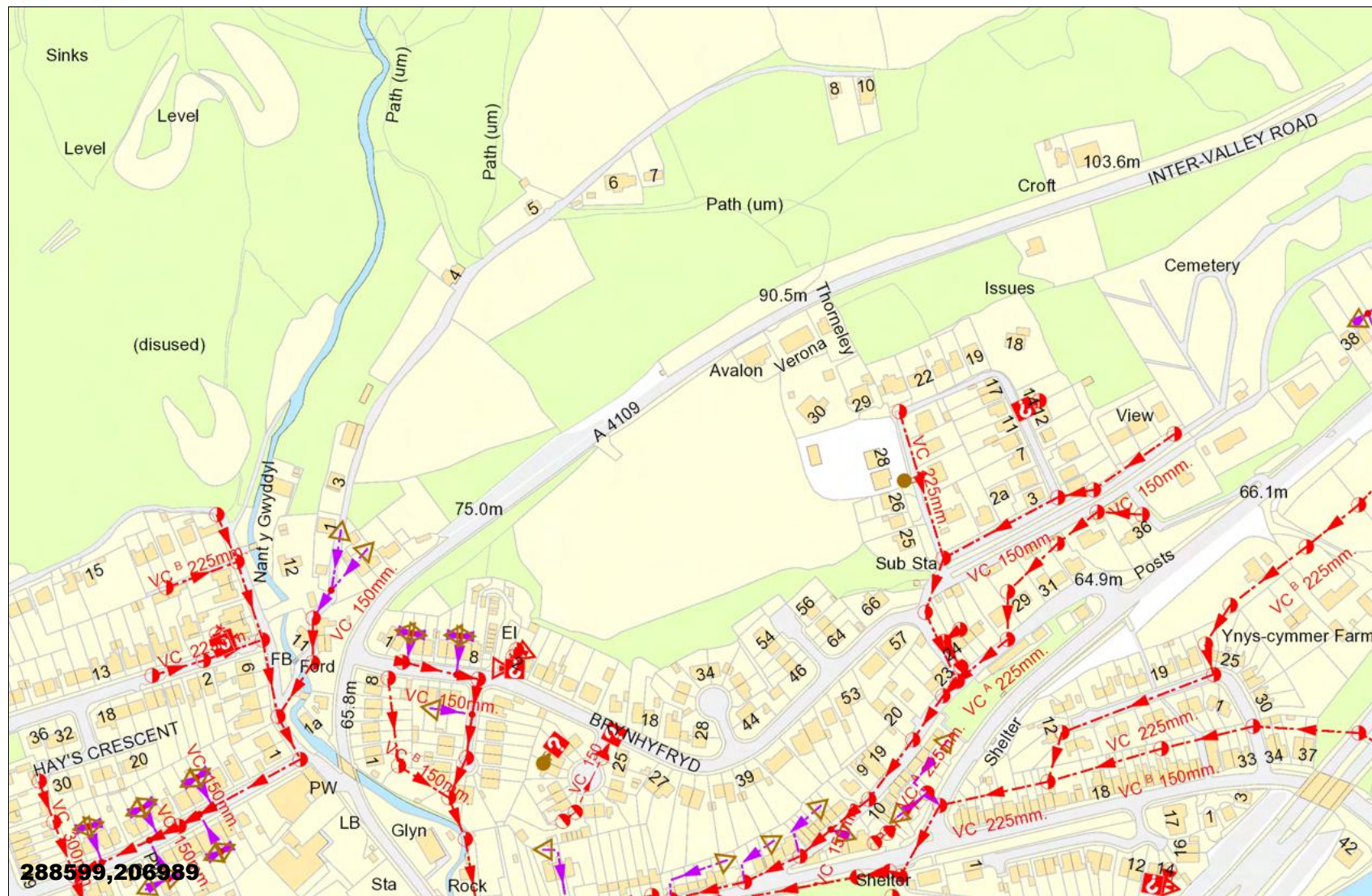

288599,206989

Dŵr Cymru Cyfyngedig ('the Company') gives this information as to the position of its underground apparatus by way of general guidance only and on the strict understanding that it is based on the best information available and no warranty as to its correctness is relied upon in the event of excavations or other works made in the vicinity of the company's apparatus and any onus of locating the apparatus before carrying out any excavations rests entirely on you. The information which is supplied hereby by the company, is done so in accordance with statutory requirements of sections 198 and 199 of the water industry Act 1991 based upon the best information available and in particular, but without prejudice to the generality of the foregoing, it should be noted that the records that are available to the Company may not disclose the existence of a drain sewer or disposal main laid before 1 September 1989, or if they do, the particulars thereof including their position underground may not be accurate. It must be understood that the furnishing of this information is entirely without prejudice to the provision of the New Roads and Street Works Act 1991 and the company's right to be compensated for any damage to its apparatus.

**EXACT LOCATION OF
ALL APPARATUS TO
BE DETERMINED ON
SITE**

Reproduced from the Ordnance Survey's maps with the permission of the Controller of Her Majesty's Stationary Office. Crown Copyright. Licence No: WU298565.

Whilst every reasonable effort has been taken to correctly record the pipe material of DCWW assets, there is a possibility that in some cases pipe material (other than Asbestos Cement or Pitch Fibre) may be found to be Asbestos Cement (AC) or Pitch Fibre (PF). It is therefore advisable that the possible presence of AC or PF pipes be anticipated and considered as part of any risk assessment prior to excavation.



10K Raster Mapping

Published 2000

Source map scale - 1:10,000

The historical maps shown were produced from the Ordnance Survey's 1:10,000 colour raster mapping. These maps are derived from Landplan which replaced the old 1:10,000 maps originally published in 1970. The data is highly detailed showing buildings, fences and field boundaries as well as all roads, tracks and paths. Road names are also included together with the relevant road number and classification. Boundary information depiction includes county, unitary authority, district, civil parish and constituency.

Map Name(s) and Date(s)

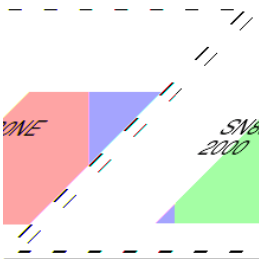

Historical Map - Slice A

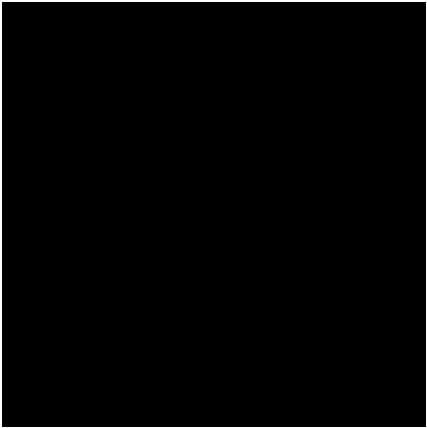

Order Details

Order Number: 24537603_1_1
Customer Ref: 10287
National Grid Reference: 288580, 206940
Slice: A
Site Area (Ha): 2.71
Search Buffer (m): 1000

Site Details

Intervalley Road, Glynneath, Neath, SA11 5TU



Tel: 0870 850 6670
Fax: 0870 850 6671
Web: www.envirocheck.co.uk

Rev	Amendments	Date	By

1. SITE GRID AND LEVELS ARE BASED UPON
ORDNANCE SURVEY VIA THE ACTIVE GPS
NETWORK.

Do not scale this drawing

This drawing is copyright.

- [illegible]

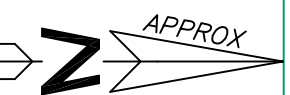

Alpine Land Surveyors Ltd
Tower Business Centre, Hinwain
Industrial Estate, Hinwain,
Abertawe, CF44 9LP
Tel/Fax: 01685 814544 Mobile:
07930 404 208
j.prior@alpinelandsurveyors.co.uk

NT

ENZO'S HOMES LTD

TOPOGRAPHICAL SURVEY
HEOL Y GLYN,
GLYNNEATH

Scores 1:200	Date 15/03/19
Drawn TC	Checked: CS
Project Reference No.	ALS/02373
Drawing Number	ENZ/HYG/T02

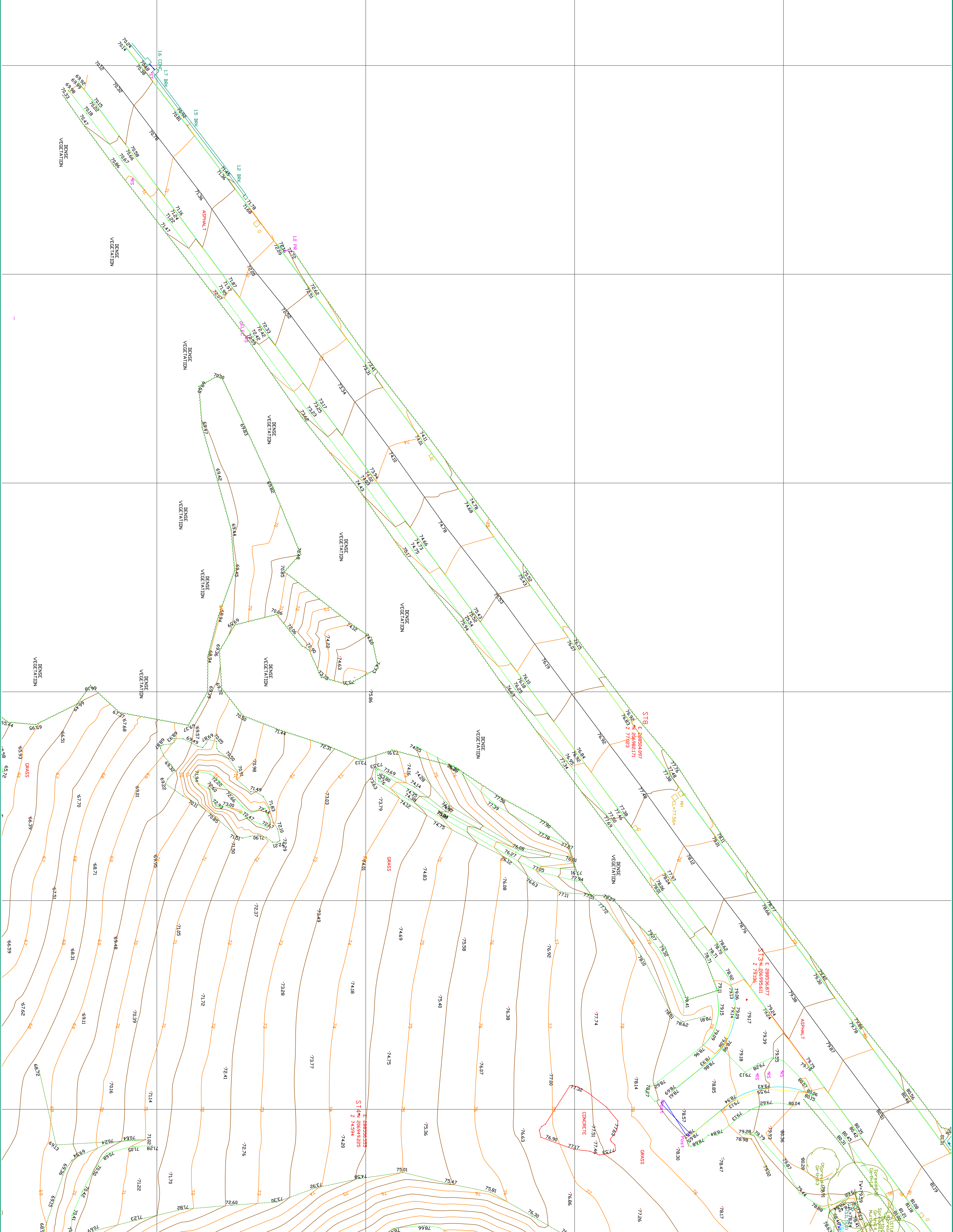

Rev	Amendments	Date	By

1. SITE GRID AND LEVELS ARE BASED UPON ORDNANCE SURVEY VIA THE ACTIVE GPS NETWORK.

Do not scale this drawing

This drawing is copyright.

[illegible]

Alpine Land Surveyors Ltd
: Tower Business Centre, Hivwaun
Industrial Estate, Hivwaun,
Aberdare, CF44 9JP
Tel/fax: 01685 814544 Mobile:
07990 404 208
j.pnce@aipnelandsurveyors.co.uk

ENT

ENZO'S HOMES LTD

TOPOGRAPHICAL SURVEY
HEOL Y GLYN,
GLYNNEATH

Scales	1:200	Date	15/03/19
Drawn	TC	Checked:	CS
Project Reference No.	ALS/02373		
Drawing Number	ENZ/HYG/T04		

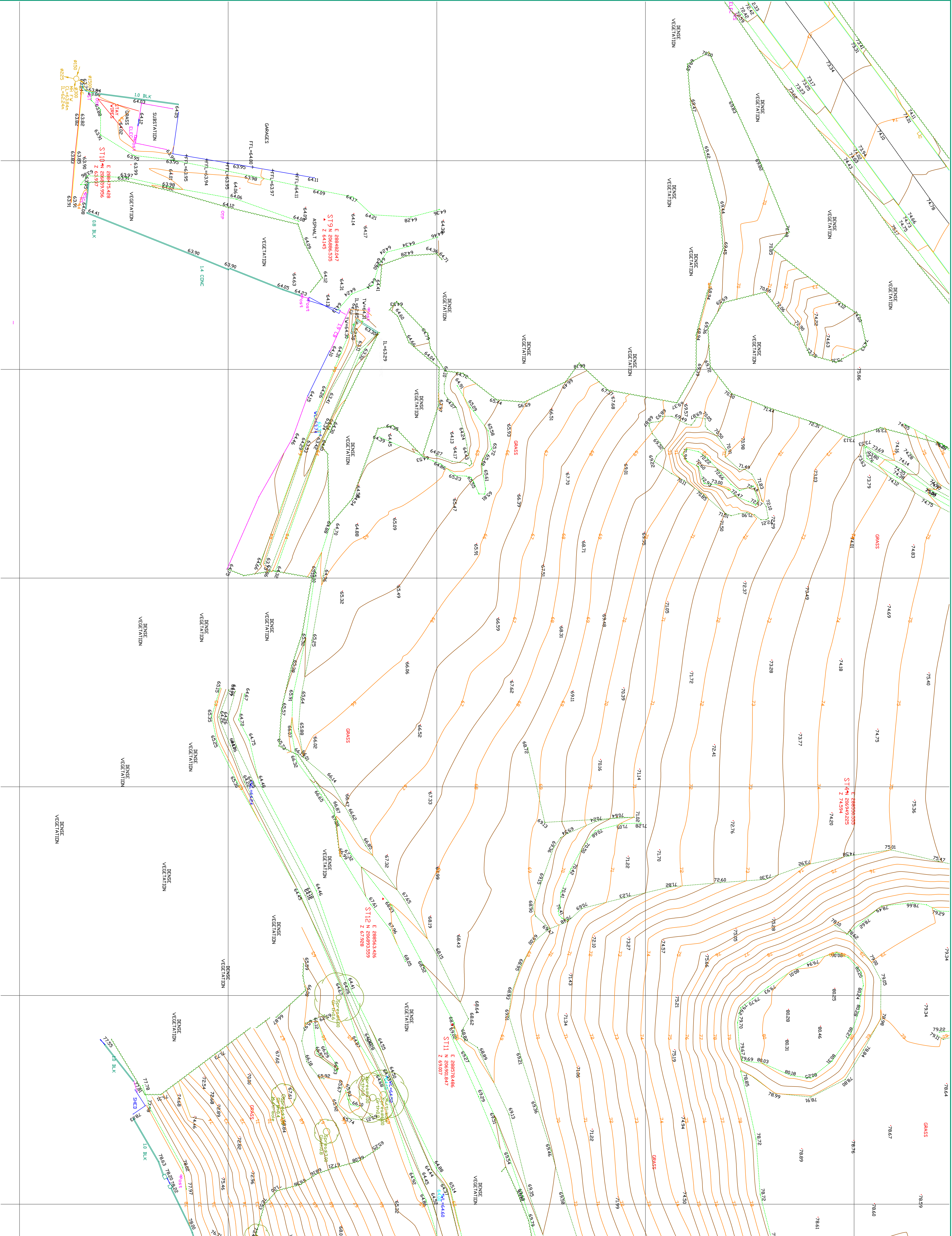

Rev	Amendments	Date	By

1. SITE GRID AND LEVELS ARE BASED UPON ORDINANCE SURVEY VIA THE ACTIVE GPS NETWORK.

Do not scale this drawing.

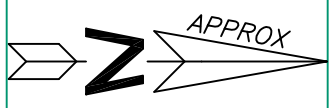
[illegible]

Alpine Land Surveyors Ltd
 . Tower Business Centre, Hirwaun,
 Industrial Estate, Hirwaun,
 Aberdare, CF44 9JP
 Tel/fax: 01685 814544 Mobile:
 07980 404 208
 i.price@alpinelandsurveyors.co.uk

CLIENT

ENZO'S HOMES LTD

PROJECT
TOPOGRAPHICAL SURVEY
HEOL Y GLYN,
GLYNNNEATH

Scales 1:200	Date 15/03/1
Down TC	Checked: CS
Project Reference No.	ALS/02373
Drawing Number	ENZ/HYG/T05

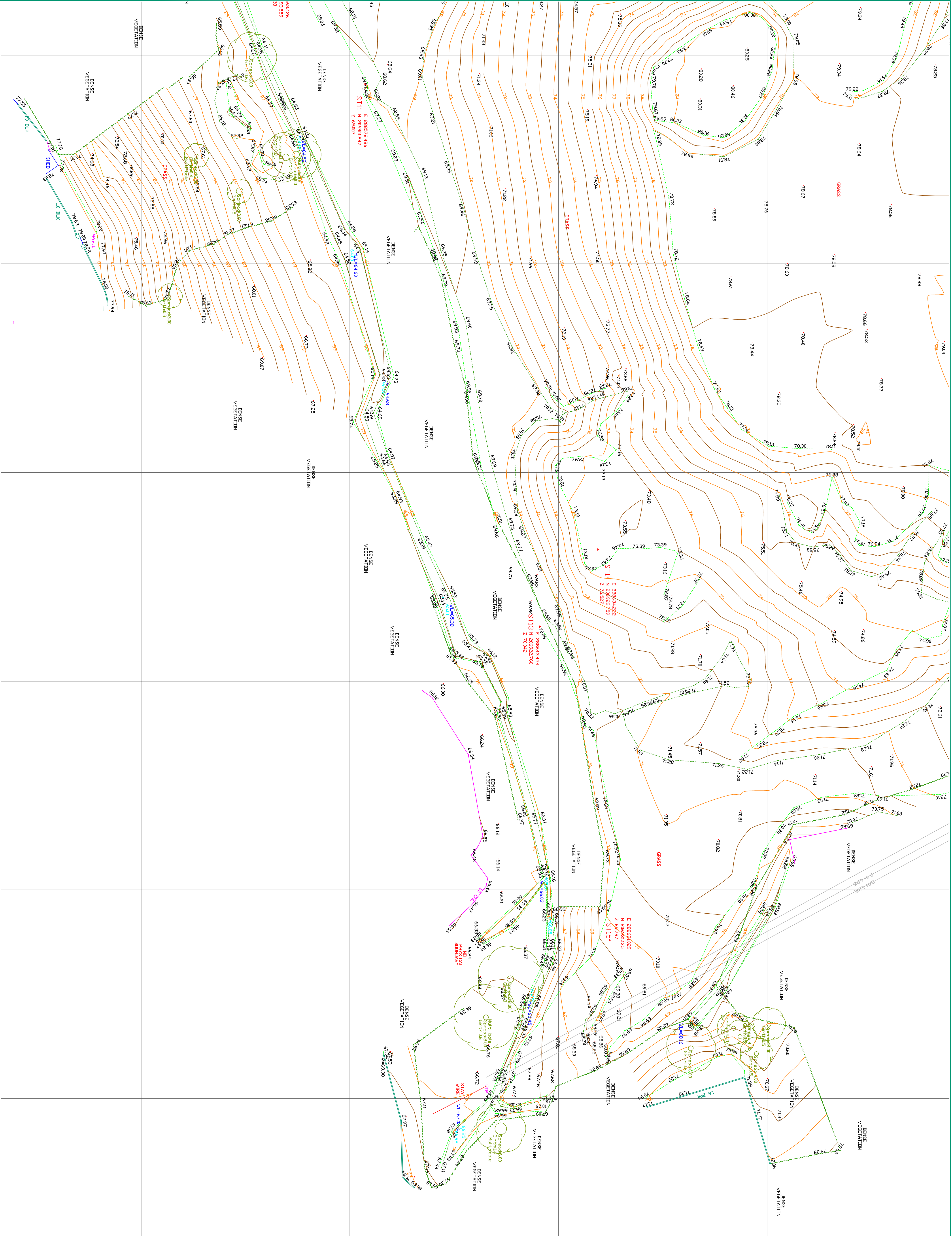

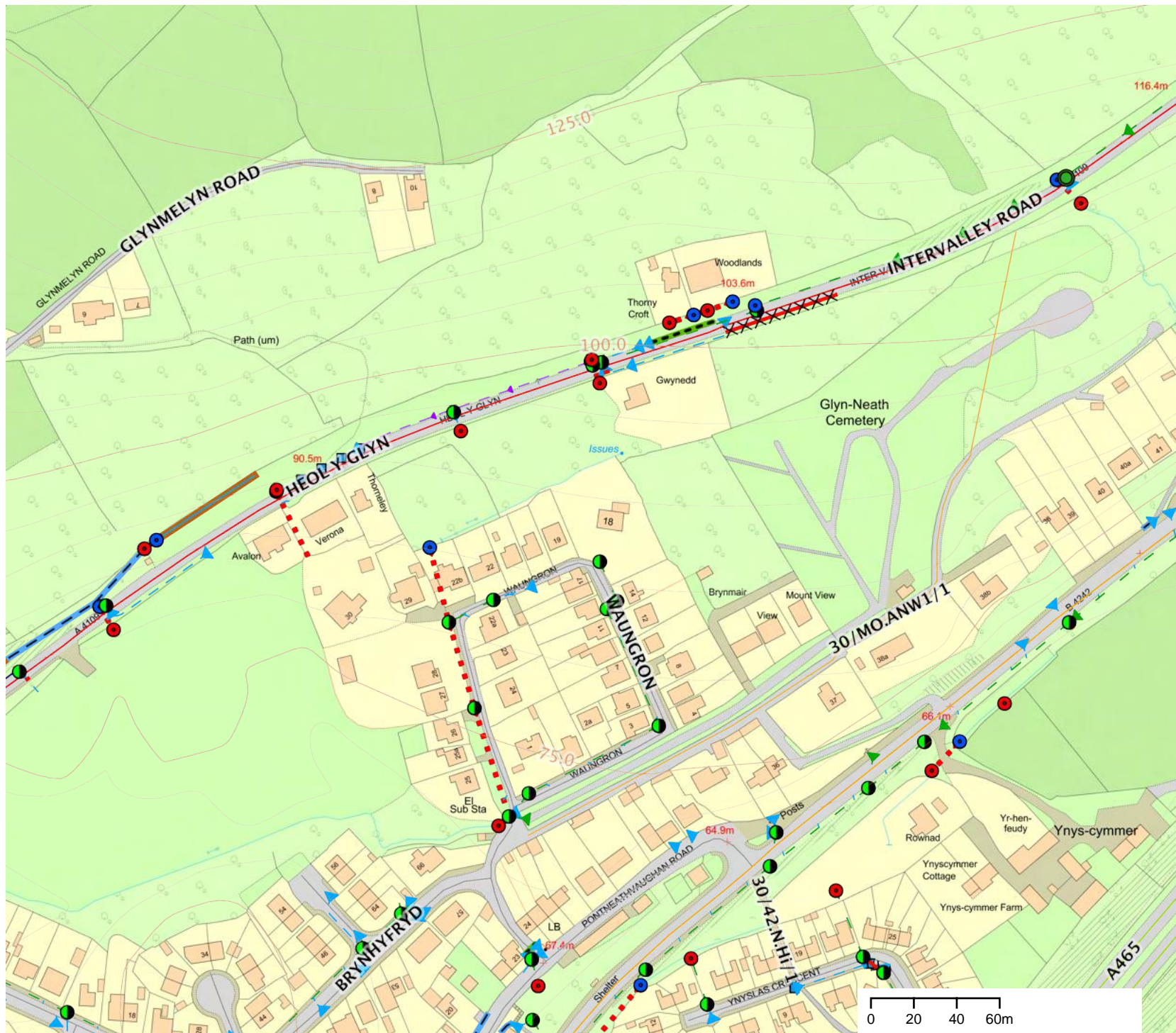

Title:

GeoDiscoverer

Scale: 1:2500

Created by:

ts067

Date: 14/10/2020

Description:

Page printed from
GeoDiscoverer





Title:

GeoDiscoverer

Scale: 1:2500

Created by:

ts067

Date: 14/10/2020

Description:

Page printed from
GeoDiscoverer

